



LKM metal cable trunking systems

	Trunking height 24 mm	198
	Trunking height 30 mm	200
	Trunking height 40 mm	201
	Trunking height 60 mm	205
	Trunking height 80 mm	213
	Accessories	215

Trunking height 24 mm, trunking width 20 mm

Trunking, type LKM 20020

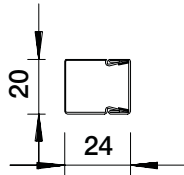

Type	Col-our	Length mm	Pack. m	Weight kg/100 m	Item No.
LKM20020FS	—	2000	32	46,000	6246 96 6
LKM20020RW	Pure white	2000	30	52,000	6248 46 2

/m

Trunking cover and base with base perforation.

Equipotential bonding is guaranteed between the cover and the base without any additional aids.

Joint connector

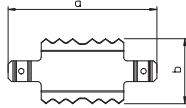

Type	Dimen- sion a mm	Dimen- sion b mm	Pack. pcs	Weight kg/100 pcs.	Item No.
LKM SV20	45	19.7	10	0,190	6247 43 1

/pc.

Joint connector for connecting the bases.

This creates the equipotential bonding between the trunking bases.

Edge protection ring

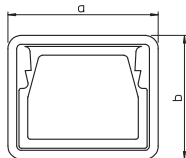

Type	Col-our	Dimen- sion a mm	Dimen- sion b mm	Pack. pcs	Weight kg/100 pcs.	Item No.
KSR20020	Grey	28	24	5	0,900	6249 84 2

/pc.

PE Polyethylene

Edge protection ring for the open ends of LKM cable trunking.

Trunking, type LKM 20030

Type	Colour	Length mm	Pack. m	Weight kg/100 m	Item No.
LKM20030FS	—	2000	24	58,000	6246 97 4
LKM20030RW	Pure white	2000	22	58,000	6248 47 0

/m

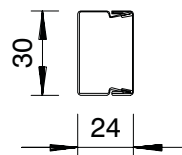

Trunking cover and base with base perforation.

Equipotential bonding is guaranteed between the cover and the base without any additional aids.

Joint connector

Type	Dimension a mm	Dimension b mm	Pack. pcs	Weight kg/100 pcs.	Item No.
LKM SV30	53.8	29.5	10	0,400	6247 43 4

/pc.

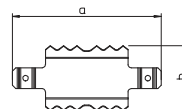

Joint connector for connecting the bases.

This creates the equipotential bonding between the trunking bases.

Edge protection ring

Type	Colour	Dimension a mm	Dimension b mm	Pack. pcs	Weight kg/100 pcs.	Item No.
KSR20030	Grey	34	28	5	1,100	6249 84 4

/pc.

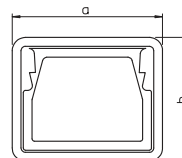

PE Polyethylene

Edge protection ring for the open ends of LKM cable trunking.

Trunking height 30 mm, trunking width 30 mm

Trunking, type LKM 30030

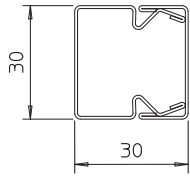

Type	Col- our	Length mm	Pack. m	Weight kg/100 m	Item No.
LKM30030FS	—	2000	16	107,000	6246 98 2
LKM30030RW	Pure white	2000	16	100,000	6248 48 2

SI Steel
FS Strip-galvanised FSK Strip galvanised/powder-coated /m

Trunking cover and base with base perforation.
Equipotential bonding is guaranteed between the cover and the base without any additional aids.

Joint connector

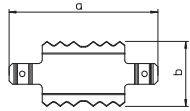

Type	Dimen- sion a mm	Dimen- sion b mm	Pack. pcs	Weight kg/100 pcs.	Item No.
LKM SV30	53.8	29.5	10	0,400	6247 43 4

/pc.

Joint connector for connecting the bases.
This creates the equipotential bonding between the trunking bases.

Edge protection ring

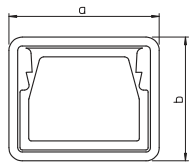

Type	Col- our	Dimen- sion a mm	Dimen- sion b mm	Pack. pcs	Weight kg/100 pcs.	Item No.
KSR30030	Grey	34	34	5	1,300	6249 84 5

/pc.

Edge protection ring for the open ends of LKM cable trunking.

Trunking, type LKM 40040

Type	Colour	Length mm	Pack. m	Weight kg/100 m	Item No.
LKM40040FS	—	2000	16	117,000	6246 99 0
LKM40040RW	Pure white	2000	12	127,600	6248 49 7

/m

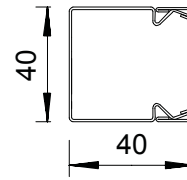

Trunking cover and base with floor perforation.

Equipotential bonding is guaranteed between the cover and the base without any additional aids.

Joint connector

Type	Dimension a mm	Dimension b mm	Pack. pcs	Weight kg/100 pcs.	Item No.
LKM SV40	76	29.6	10	1,000	6247 45 8

/pc.

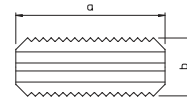

Joint connector to connect the bases.

This creates the equipotential bonding between the trunking bases.

Internal corner

Type	Colour	Dimension a mm	Pack. pcs	Weight kg/100 pcs.	Item No.
LKM I40040FS	—	160	4	28,000	6247 65 2
LKM I40040RW	Pure white	160	4	28,000	6249 16 7

/pc.

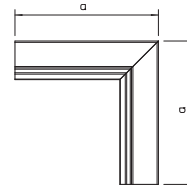

Internal corner for changing the direction of the LKM trunking.

External corner

Type	Colour	Dimension a mm	Pack. pcs	Weight kg/100 pcs.	Item No.
LKM A40040FS	—	160	4	38,600	6247 56 3
LKM A40040RW	Pure white	160	4	38,600	6249 08 6

/pc.

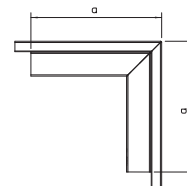

External corner including cover for changing the direction of the LKM trunking.

T piece

Type	Colour	Dimension a mm	Dimension b mm	Pack. pcs	Weight kg/100 pcs.	Item No.
LKM T40040FS	—	280	140	4	39,700	6247 72 5
LKM T40040RW	Pure white	280	140	4	39,700	6249 25 6

/pc.

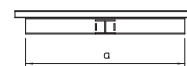

T piece including cover for changing the direction of the LKM trunking.

Flat angle

Type	Colour	Dimension a mm	Pack. pcs	Weight kg/100 pcs.	Item No.
LKM F40040FS	—	160	4	37,100	6247 49 0
LKM F40040RW	Pure white	160	4	37,100	6248 99 3

/pc.

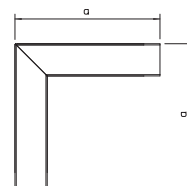

Flat angle including cover for changing the direction of the LKM trunking.

Trunking height 40 mm, trunking width 40 mm

End piece

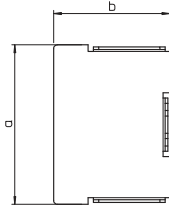

Type	Col- our	Dimen- sion a mm	Dimen- sion b mm	Pack. pcs	Weight kg/100 pcs.	Item No.
LKM E40040FS	—	40	38	10	2,500	6247 88 1
LKM E40040RW	Pure white	40	38	10	2,500	6249 41 8

/pc.

End piece for closing the LKM trunking.

Edge protection ring

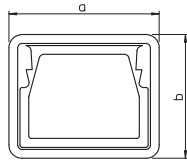

Type	Col- our	Dimen- sion a mm	Dimen- sion b mm	Pack. pcs	Weight kg/100 pcs.	Item No.
KSR40040	Grey	47.7	44	5	1,800	6249 84 6

PE Polyethylene

/pc.

Edge protection ring for the open ends of LKM cable trunking.

Trunking, type LKM 40060

Type	Colour	Length mm	Pack. m	Weight kg/100 m	Item No.
LKM40060FS	—	2000	8	151,200	6247 01 6
LKM40060RW	Pure white	2000	8	151,200	6248 51 9

/m

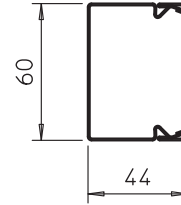

Trunking cover and base with base perforation.

Equipotential bonding is guaranteed between the cover and the base without any additional aids.

Joint connector

Type	Dimension a mm	Dimension b mm	Pack. pcs	Weight kg/100 pcs.	Item No.
LKM SV40	76	29.6	10	1,000	6247 45 8

/pc.

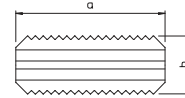

Joint connector to connect the bases.

This creates the equipotential bonding between the trunking bases.

Internal corner

Type	Colour	Dimension a mm	Pack. pcs	Weight kg/100 pcs.	Item No.
LKM I40060FS	—	160	4	31,400	6247 66 0
LKM I40060RW	Pure white	160	4	31,400	6249 17 5

/pc.

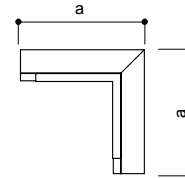

Internal corner for changing the direction of the LKM trunking.

External corner

Type	Colour	Dimension a mm	Pack. pcs	Weight kg/100 pcs.	Item No.
LKM A40060FS	—	160	4	46,300	6247 57 1
LKM A40060RW	Pure white	160	4	46,300	6249 09 4

/pc.

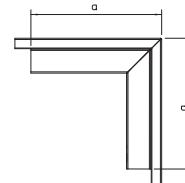

External corner including cover for changing the direction of the LKM trunking.

T piece

Type	Colour	Dimension a mm	Dimension b mm	Pack. pcs	Weight kg/100 pcs.	Item No.
LKM T40060FS	—	300	180	4	46,800	6247 73 3
LKM T40060RW	Pure white	300	180	4	46,800	6249 26 4

/pc.

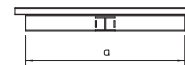

T piece including cover for changing the direction of the LKM trunking.

Flat angle

Type	Colour	Dimension a mm	Pack. pcs	Weight kg/100 pcs.	Item No.
LKM F40060FS	—	180	4	47,400	6247 50 4
LKM F40060RW	Pure white	180	4	47,400	6249 00 0

/pc.

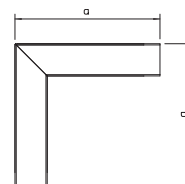

Flat angle including cover for changing the direction of the LKM trunking.

Trunking height 40 mm, trunking width 60 mm

End piece

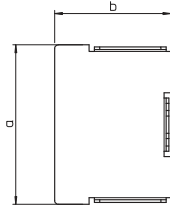

Type	Col-our	Dimen- sion a mm	Dimen- sion b mm	Pack. pcs	Weight kg/100 pcs.	Item No.
LKM E40060FS	—	60	38	10	3,000	6247 90 3
LKM E40060RW	Pure white	60	38	10	3,000	6249 42 6

/pc.

End piece for closing the LKM trunking.

Edge protection ring

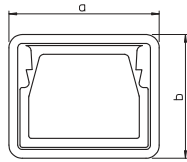

Type	Col-our	Dimen- sion a mm	Dimen- sion b mm	Pack. pcs	Weight kg/100 pcs.	Item No.
KSR40060	Grey	47	64	5	2,300	6249 84 8

PE Polyethylene

/pc.

Edge protection ring for the open ends of LKM cable trunking.

Trunking, type LKM 60060

Type	Colour	Length mm	Pack. m	Weight kg/100 m	Item No.
LKM60060FS	—	2000	8	174,700	6247 09 1
LKM60060RW	Pure white	2000	8	174,700	6248 60 8

/m

Trunking cover and base with base perforation. Equipotential bonding is guaranteed between the cover and the base without any additional aids. Note: LKM 60060 has no loop perforation in the base, a partition cannot be installed.

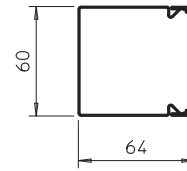

Joint connector

Type	Dimension a mm	Dimension b mm	Pack. pcs	Weight kg/100 pcs.	Item No.
LKM SV60	75	50	10	1,600	6247 46 6

/pc.

Joint connector to connect the bases. This creates the equipotential bonding between the trunking bases.

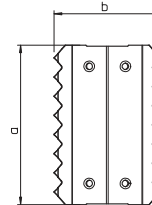

Internal corner

Type	Colour	Dimension a mm	Pack. pcs	Weight kg/100 pcs.	Item No.
LKM I60060FS	—	180	4	31,900	6248 12 8
LKM I60060RW	Pure white	180	4	31,900	6249 61 2

/pc.

Internal corner for changing the direction of the LKM trunking.

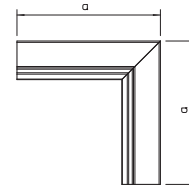

External corner

Type	Colour	Dimension a mm	Pack. pcs	Weight kg/100 pcs.	Item No.
LKM A60060FS	—	180	4	55,800	6248 04 7
LKM A60060RW	Pure white	180	4	55,800	6249 55 8

/pc.

External corner including cover for changing the direction of the LKM trunking.

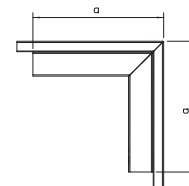

T piece

Type	Colour	Dimension a mm	Dimension b mm	Pack. pcs	Weight kg/100 pcs.	Item No.
LKM T60060FS	—	300	180	4	54,200	6248 18 7
LKM T60060RW	Pure white	300	180	4	54,200	6249 67 1

/pc.

T piece including cover for changing the direction of the LKM trunking.

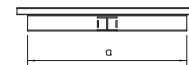

Flat angle

Type	Colour	Dimension a mm	Pack. pcs	Weight kg/100 pcs.	Item No.
LKM F60060FS	—	180	4	54,700	6247 98 9
LKM F60060RW	Pure white	180	4	54,700	6249 48 5

/pc.

Flat angle including cover for changing the direction of the LKM trunking.

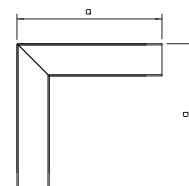

Trunking height 60 mm, trunking width 60 mm

End piece

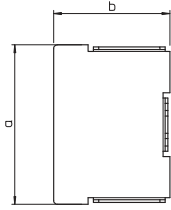

Type	Col-our	Dimen- sion a mm	Dimen- sion b mm	Pack. pcs	Weight kg/100 pcs.	Item No.
LKM E60060FS	—	63	60	10	4,500	6248 28 4
LKM E60060RW	Pure white	63	60	10	4,500	6249 79 5

/pc.

End piece for closing the LKM trunking.

Edge protection ring

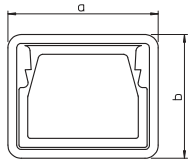

Type	Col-our	Dimen- sion a mm	Dimen- sion b mm	Pack. pcs	Weight kg/100 pcs.	Item No.
KSR60060	Grey	67.7	64	5	2,400	6249 85 0

PE Polyethylene

/pc.

Edge protection ring for the open ends of LKM cable trunking.

Trunking, type LKM 60100

Type	Colour	Length mm	Pack. m	Weight kg/100 m	Item No.
LKM60100FS	—	2000	8	221,700	6247 11 3
LKM60100RW	Pure white	2000	8	221,700	6248 62 4

/m

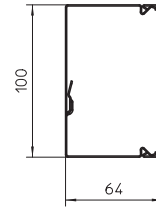

Trunking cover and base with base perforation.

Equipotential bonding is guaranteed between the cover and the base without any additional aids.

Trunking clamp for function maintenance E30–E90

Type	Pack. pcs	Weight kg/100 pcs.	Item No.
LKM KF 60100	10	9,800	6249 88 1

St Steel /pc.
FS Strip-galvanised

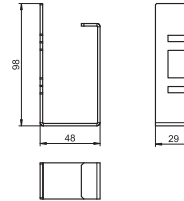

Trunking clamp for the metal cable routing trunking type LKM 60100FS, prevents the cables falling out during installation. The trunking clamp is essential if the trunking is used in cable systems with integrated function maintenance to DIN 4102, Part 12. Easy mounting through insertion into the loop perforation in the side wall.

Joint connector

Type	Dimension a mm	Dimension b mm	Pack. pcs	Weight kg/100 pcs.	Item No.
LKM SV60	75	50	10	1,600	6247 46 6

/pc.

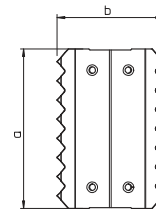

Joint connector to connect the bases.

This creates the equipotential bonding between the trunking bases.

Internal corner

Type	Colour	Dimension a mm	Pack. pcs	Weight kg/100 pcs.	Item No.
LKM I60100FS	—	180	4	39,400	6248 14 4
LKM I60100RW	Pure white	180	4	39,400	6249 63 9

/pc.

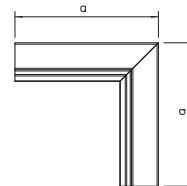

Internal corner for changing the direction of the LKM trunking.

External corner

Type	Colour	Dimension a mm	Pack. pcs	Weight kg/100 pcs.	Item No.
LKM A60100FS	—	180	4	73,100	6248 06 3
LKM A60100RW	Pure white	180	4	73,100	6249 57 4

/pc.

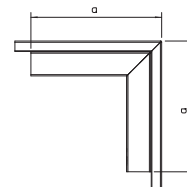

External corner including cover for changing the direction of the LKM trunking.

T piece

Type	Colour	Dimension a mm	Dimension b mm	Pack. pcs	Weight kg/100 pcs.	Item No.
LKM T60100FS	—	340	220	4	69,200	6248 20 9
LKM T60100RW	Pure white	340	220	4	69,200	6249 70 1

/pc.

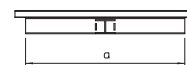

T piece including cover for changing the direction of the LKM trunking.

Flat angle

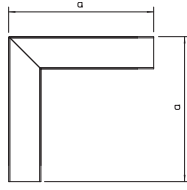

Type	Col-our	Dimen- sion a mm	Pack. pcs	Weight kg/100 pcs.	Item No.
LKM F60100FS	—	220	4	63,400	6248 00 4
LKM F60100RW	Pure white	220	4	63,400	6249 50 7

/pc.

Flat angle including cover for changing the direction of the LKM trunking.

End piece

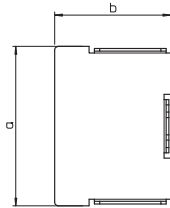

Type	Col-our	Dimen- sion a mm	Dimen- sion b mm	Pack. pcs	Weight kg/100 pcs.	Item No.
LKM E60100FS	—	100	63	10	6,200	6248 30 6
LKM E60100RW	Pure white	100	63	10	6,500	6249 81 7

/pc.

End piece for closing the LKM trunking.

Edge protection ring

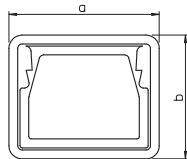

Type	Col-our	Dimen- sion a mm	Dimen- sion b mm	Pack. pcs	Weight kg/100 pcs.	Item No.
KSR60100	Grey	104	67.7	5	3,400	6249 85 2

PE Polyethylene

/pc.

Edge protection ring for the open ends of LKM cable trunking.

Trunking, type LKM 60150

Type	Colour	Length mm	Pack. m	Weight kg/100 m	Item No.
LKM60150FS	—	2000	8	280,100	6247 14 8
LKM60150RW	Pure white	2000	8	280,100	6248 64 0

/m

Trunking cover and base with base perforation.

Equipotential bonding is guaranteed between the cover and the base without any additional aids.

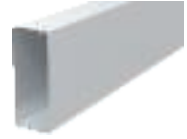
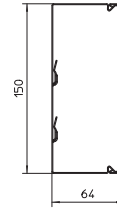

Joint connector

Type	Dimension a mm	Dimension b mm	Pack. pcs	Weight kg/100 pcs.	Item No.
LKM SV60	75	50	10	1,600	6247 46 6

/pc.

Joint connector to connect the bases.

This creates the equipotential bonding between the trunking bases.

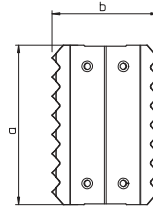

Internal corner

Type	Colour	Dimension a mm	Pack. pcs	Weight kg/100 pcs.	Item No.
LKM I60150FS	—	180	4	48,400	6248 15 2
LKM I60150RW	Pure white	180	4	48,400	6249 64 7

/pc.

Internal corner for changing the direction of the LKM trunking.

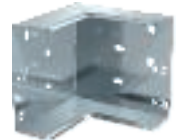
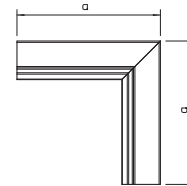

External corner

Type	Colour	Dimension a mm	Pack. pcs	Weight kg/100 pcs.	Item No.
LKM A60150FS	—	180	4	91,300	6248 07 1
LKM A60150RW	Pure white	180	4	91,300	6249 58 2

/pc.

External corner including cover for changing the direction of the LKM trunking.

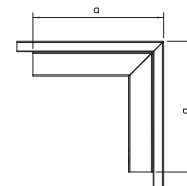

T piece

Type	Colour	Dimension a mm	Dimension b mm	Pack. pcs	Weight kg/100 pcs.	Item No.
LKM T60150FS	—	390	270	4	87,600	6248 21 7
LKM T60150RW	Pure white	390	270	4	87,600	6249 72 8

/pc.

T piece including cover for changing the direction of the LKM trunking.

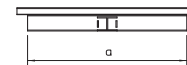

Flat angle

Type	Colour	Dimension a mm	Pack. pcs	Weight kg/100 pcs.	Item No.
LKM F60150FS	—	270	4	113,500	6248 01 2
LKM F60150RW	Pure white	270	4	113,500	6249 51 5

/pc.

Flat angle including cover for changing the direction of the LKM trunking.

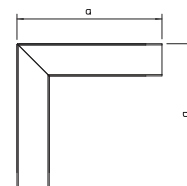

Trunking height 60 mm, trunking width 150 mm

End piece

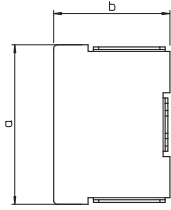

Type	Col- our	Dimen- sion a mm	Dimen- sion b mm	Pack. pcs	Weight kg/100 pcs.	Item No.
LKM E60150FS	—	150	63	10	8,400	6248 31 4
LKM E60150RW	Pure white	150	63	10	9,000	6249 82 5

/pc.

End piece for closing the LKM trunking.

Edge protection ring

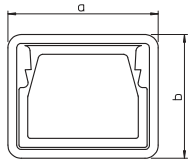

Type	Col- our	Dimen- sion a mm	Dimen- sion b mm	Pack. pcs	Weight kg/100 pcs.	Item No.
KSR60150	Grey	154	67.7	5	4,400	6249 85 4

PE Polyethylene

/pc.

Edge protection ring for the open ends of LKM cable trunking.

Trunking, type LKM 60200

Type	Colour	Length mm	Pack. m	Weight kg/100 m	Item No.
LKM60200FS	—	2000	8	338,700	6247 16 4
LKM60200RW	Pure white	2000	8	338,700	6248 66 7

/m

Trunking cover and base with base perforation.

Equipotential bonding is guaranteed between the cover and the base without any additional aids.

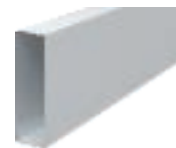
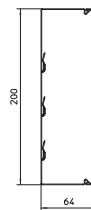

Joint connector

Type	Dimension a mm	Dimension b mm	Pack. pcs	Weight kg/100 pcs.	Item No.
LKM SV60	75	50	10	1,600	6247 46 6

/pc.

Joint connector to connect the bases.

This creates the equipotential bonding between the trunking bases.

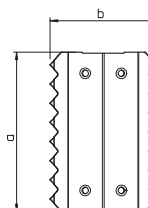

Internal corner

Type	Colour	Dimension a mm	Pack. pcs	Weight kg/100 pcs.	Item No.
LKM I60200FS	—	180	4	57,500	6248 16 0
LKM I60200RW	Pure white	180	4	57,500	6249 65 5

/pc.

Internal corner for changing the direction of the LKM trunking.

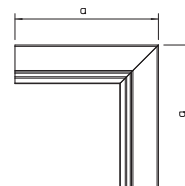

External corner

Type	Colour	Dimension a mm	Pack. pcs	Weight kg/100 pcs.	Item No.
LKM A60200FS	—	180	4	114,000	6248 09 8
LKM A60200RW	Pure white	180	4	114,000	6249 59 0

/pc.

External corner including cover for changing the direction of the LKM trunking.

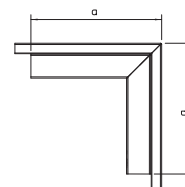

T piece

Type	Colour	Dimension a mm	Dimension b mm	Pack. pcs	Weight kg/100 pcs.	Item No.
LKM T60200FS	—	440	320	4	106,000	6248 22 5
LKM T60200RW	Pure white	440	320	4	106,000	6249 73 6

/pc.

T piece including cover for changing the direction of the LKM trunking.

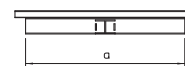

Flat angle

Type	Colour	Dimension a mm	Pack. pcs	Weight kg/100 pcs.	Item No.
LKM F60200FS	—	320	4	154,400	6248 02 0
LKM F60200RW	Pure white	320	4	154,400	6249 52 3

/pc.

Flat angle including cover for changing the direction of the LKM trunking.

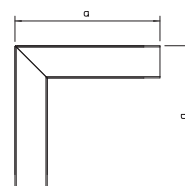

Trunking height 60 mm, trunking width 200 mm

End piece

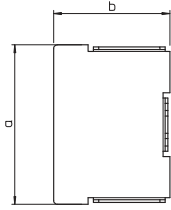

Type	Col-our	Dimen- sion a mm	Dimen- sion b mm	Pack. pcs	Weight kg/100 pcs.	Item No.
LKM E60200FS	—	200	63	10	10,800	6248 32 2
LKM E60200RW	Pure white	200	63	10	11,500	6249 83 3

/pc.

End piece for closing the LKM trunking.

Edge protection ring

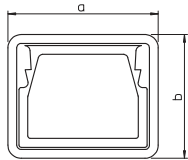

Type	Col-our	Dimen- sion a mm	Dimen- sion b mm	Pack. pcs	Weight kg/100 pcs.	Item No.
KSR60200	Grey	204	67.7	5	4,700	6249 85 6

PE Polyethylene

/pc.

Edge protection ring for the open ends of LKM cable trunking.

Trunking, type LKM 80080

Type	Colour	Length mm	Pack. m	Weight kg/100 m	Item No.
LKM80080FS	—	2000	12	183,500	6247 19 4
LKM80080RW	Pure white	2000	8	238,000	6248 69 4

St Steel
FS Strip-galvanised FSK Strip galvanised/powder-coated

Trunking cover and base with base perforation.

Equipotential bonding is guaranteed between the cover and the base without any additional aids.

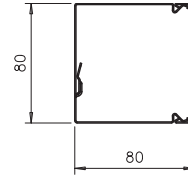

Joint connector

Type	Dimension a mm	Dimension b mm	Pack. pcs	Weight kg/100 pcs.	Item No.
LKM SV80	75	65.6	10	1,300	6247 47 2

St Steel /pc.

Joint connector to connect the bases.

This creates the equipotential bonding between the trunking bases.

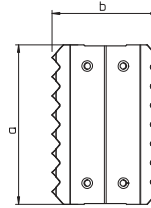

Internal corner

Type	Colour	Dimension a mm	Pack. pcs	Weight kg/100 pcs.	Item No.
LKM I80080FS	—	160	1	38,700	6248 33 6
LKM I80080RW	Pure white	160	1	38,700	6248 43 6

St Steel
FS Strip-galvanised FSK Strip galvanised/powder-coated

Internal corner for changing the direction of the LKM trunking.

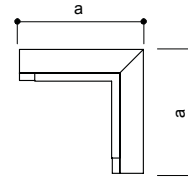

External corner

Type	Colour	Dimension a mm	Pack. pcs	Weight kg/100 pcs.	Item No.
LKM A80080FS	—	200	1	75,300	6248 33 2
LKM A80080RW	Pure white	200	1	75,300	6248 43 2

St Steel /pc.
FS Strip-galvanised FSK Strip galvanised/powder-coated

External corner including cover for changing the direction of the LKM trunking.

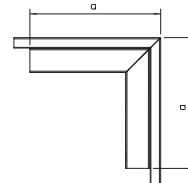

T piece

Type	Colour	Dimension a mm	Pack. pcs	Weight kg/100 pcs.	Item No.
LKM T80080FS	—	300	1	67,200	6248 34 0
LKM T80080RW	Pure white	300	1	67,200	6248 45 0

St Steel
FS Strip-galvanised FSK Strip galvanised/powder-coated

T piece, including cover, for changing the direction of the LKM trunking.

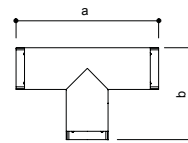

Flat angle

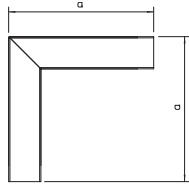

Type	Col-our	Dimen- sion a mm	Pack. pcs	Weight kg/100 pcs.	Item No.
LKM F80080FS	—	240	1	80,000	6248 32 8
LKM F80080RW	Pure white	240	1	80,000	6248 42 8

St Steel

FS Strip-galvanised FSK Strip galvanised/powder-coated

/pc.

Flat angle including cover for changing the direction of the LKM trunking.

End piece

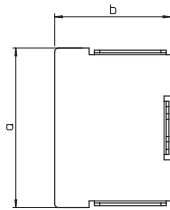

Type	Col-our	Dimen- sion a mm	Dimen- sion b mm	Pack. pcs	Weight kg/100 pcs.	Item No.
LKM E80080FS	—	80	80	1	7,000	6248 34 4
LKM E80080RW	Pure white	80	80	1	7,000	6248 45 4

St Steel

FS Strip-galvanised FSK Strip galvanised/powder-coated

/pc.

End piece for closing the LKM trunking.

Edge protection ring

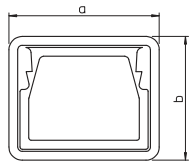

Type	Col-our	Dimen- sion a mm	Dimen- sion b mm	Pack. pcs	Weight kg/100 pcs.	Item No.
KSR80080	Grey	84	84	5	3,800	6249 86 5

PE Polyethylene

/pc.

Edge protection ring for the open ends of LKM cable trunking.

Partition

Type	Length mm	Dimen- sion a mm	Pack. m	Weight kg/100 m	Item No.
LKM TWS55	2000	55	32	53,000	6249 87 6
LKM TWS75	2000	75	32	114,000	6249 88 0

St Steel
FS Strip-galvanised

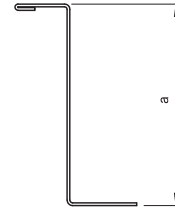

Partition to divide the LKM cable trunking, 60 mm trunking height, for different voltage levels.

Cable bracket, trunking width 60

Type	Dimen- sion a mm	Dimen- sion b mm	Pack. pcs	Weight kg/100 pcs.	Item No.
LKM Z60	46	30	10	1,100	6249 90 6

/pc.

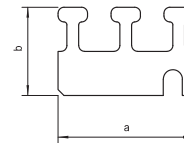

Cable fixing device for trunking width 60 mm to fix cables in vertical routing.

Cable bracket, trunking width 100

Type	Dimen- sion a mm	Dimen- sion b mm	Pack. pcs	Weight kg/100 pcs.	Item No.
LKM Z100	96	30	10	2,100	6249 92 2

/pc.

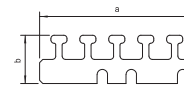

Cable fixing device for trunking width 100 mm to fix cables in vertical routing.

Cable bracket, trunking width 150

Type	Dimen- sion a mm	Dimen- sion b mm	Pack. pcs	Weight kg/100 pcs.	Item No.
LKM Z150	146	30	10	3,000	6249 96 5

/pc.

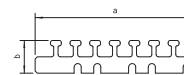

Cable fixing device for trunking width 150 mm to fix cables in vertical routing.

Cable bracket, trunking width 200

Type	Dimen- sion a mm	Dimen- sion b mm	Pack. pcs	Weight kg/100 pcs.	Item No.
LKM Z200	166	30	10	3,600	6249 98 1

/pc.

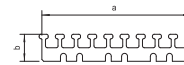

Cable fixing device for trunking width 200 mm to fix cables in vertical routing.

Trunking clamp, trunking width 100

Type	Dimen- sion a mm	Dimen- sion b mm	Dimen- sion C mm	Pack. pcs	Weight kg/100 pcs.	Item No.
LKM K80	25	80	48.5	20	2,700	6249 88 4

/100 pcs.

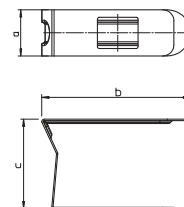

The trunking clamp keeps the inserted cables in the trunking, thus simplifying installation on walls and ceilings. The trunking clamps are plugged onto the loop perforation and locked on the side wall. Suitable for trunking width 100 mm.

Trunking clamp, trunking width 150 and 200

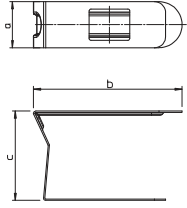

Type	Dimension a mm	Dimension b mm	Dimension C mm	Pack. pcs	Weight kg/100 pcs.	Item No.
LKM K140	25	140	48.5	20	3,600	6249 88 8

/100 pc.

The trunking clamp keeps the inserted cables in the trunking, thus simplifying installation on walls and ceilings. The trunking clamps are plugged onto the loop perforation and locked on the side wall. Suitable for trunking width 150 mm and 200 mm.

